



Town Hall / School Administration Building Project



WILMINGTON PUBLIC SCHOOLS

VOLUME 5
MAY 2022

To the Residents of Wilmington!

In the month since our last informational newsletter, the Town Hall School Administration Building Committee Chairperson, Mr. George Hooper, gave a project update at the Annual Town Meeting on April 30th summarizing the progress so far. Throughout the month of April, the THSA Building Committee has been working with the Design Team to further the project's progress. The Design Team and Building Committee have visited the various Town and School Administration departments and received feedback regarding the deficiencies in their current spaces. The Committee and Design Team have settled on a "tentative" final program to be used to continue developing the Design. This does not mean that there is no room for adjustment and change, but it gives the Team a substantial starting block when they are moving the puzzle pieces of departments around as they explore different building designs. The THSA Building Committee voted to assent the programming as presented. This programming includes the final departments that will be present in the developed building. It also ensures that each department has room to grow and flexible space for the growth of Wilmington as a municipality, as the approximate size is 43,000 square feet. This nearly doubles the size of what is currently available between the existing Town Hall and the Roman House. This increase in size further identifies the needs of Town and School Administration Departments.

Town Hall School Administration Building Committee narrows in on Design



For more information, go to the project web page wilmingtonma.gov/projects

The Design Team has had wetland scientists and civil engineers exploring the site to identify any wetlands that are present. With the information from wetland scientists and engineers, the Design Team has made some adjustments to possible building configurations that will cover the needs of the Town, as well as respecting the recommendations of the committee with the desire to ensure that the new building design "matches" Wilmington.

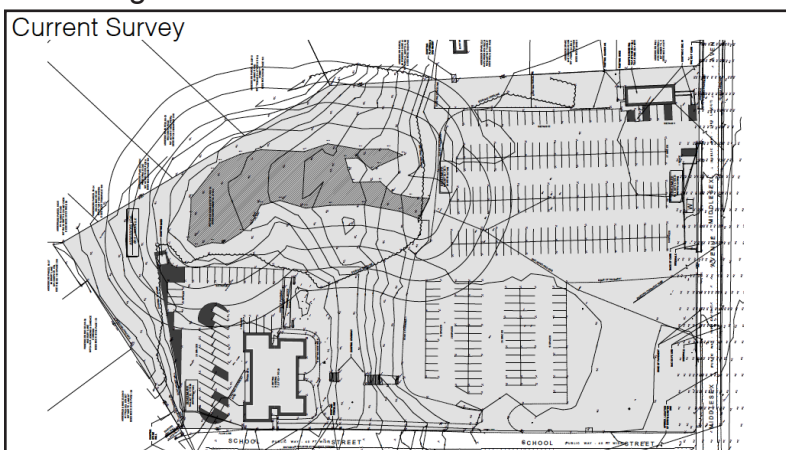

Wetlands Scientist Survey of the Site

P³

PROJECT PLANNING PROFESSIONALS
150 LONGWATER DRIVE SUITE 203 NORWELL MA 02061 781-871-3136

P - T H R E E I N C . C O M



Town Hall / School Administration Building Project



WILMINGTON PUBLIC SCHOOLS

VOLUME 5
MAY 2022

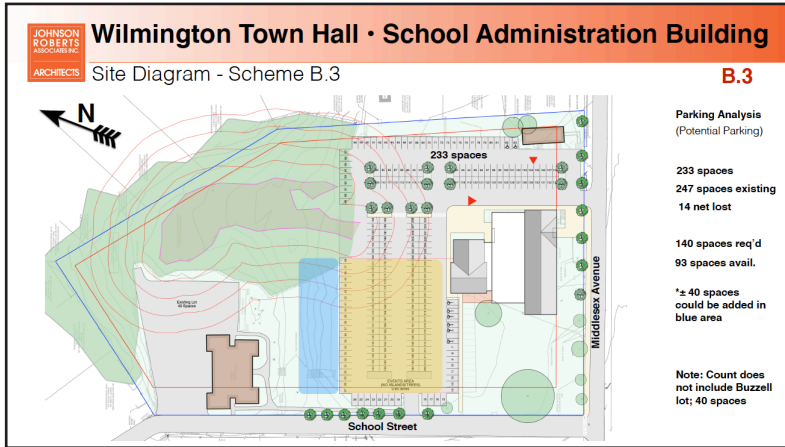

Proposed Preliminary Scheme B.3

The Building Committee has reviewed four potential building schemes, in various orientations and locations on the site. This has been the culmination of several months of design exploration. Each time the Design Team met with the Building Committee or the Town Hall and School Administration staffs, needs and wants were noted and brought to life in different ways in different design schemes. The Building Committee and the Design Team explored any and all possibilities within the site limitations while considering community requests. On May

18th, the Building Committee voted to eliminate some of the schemes, which has narrowed the options down to two.

Coming up Next...

The Building Committee will continue to meet with the design team and start to incorporate more detailed requests for the building including exterior details, energy efficiency, storage spaces, and meeting spaces.

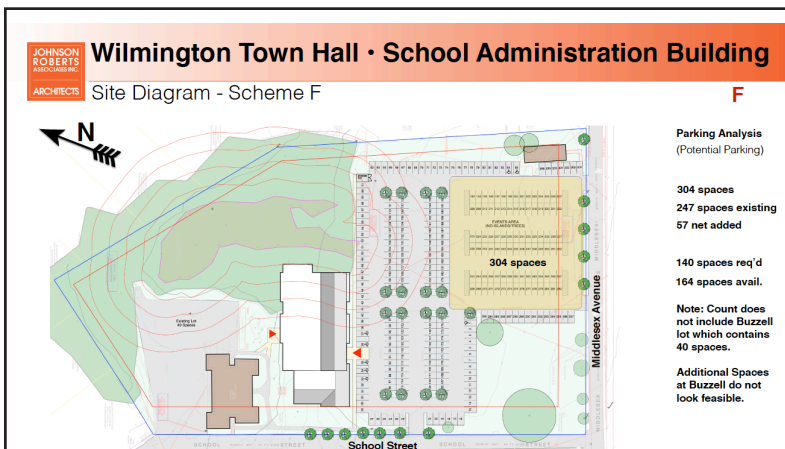

Proposed Preliminary Scheme F

