

TOWN OF WILMINGTON, MASSACHUSETTS

Woburn Street Water Main Replacement

QUESTIONS AND ANSWERS NO. 1

- Q1:** Clarify the installation method of the new steel sleeve casing in the MBTA ROW?
- A1:** Refer to Addendum No. 1. The new steel pipe (sleeve) segments, on each side of the Railroad tracks within the MBTA ROW, shall be installed using an open trench excavation method.
- Q2:** Confirm the size, wall thickness and length of the existing steel sleeve as well as the depth within the MBTA ROW.
- A2:** Refer to Addendum No. 1. Existing steel sleeve is 24” in diameter. The thickness of existing steel sleeve and depth of cover are unknown. Depth of cover over existing 24” steel sleeve could vary between 3-5 ft.

Town of Wilmington

Date: March 25, 2024

TOWN OF WILMINGTON, MASSACHUSETTS

Woburn Street Water Main Replacement

ADDENDUM NO. 1

TO ALL CONTRACTORS ESTIMATING:

Bidders are hereby informed that plans and specifications for the above-mentioned contract are modified, corrected and/or supplemented as follows and that Addendum No. 1 becomes part of the Contract Documents and consists of Items 1-1 thru 1-5.

ITEM 1-1: SECTION 00300 – Bid Schedule for Add Alternate #1

Item 325.20 For 20 Inch Steel Pipe Casing for Water Pipe, per foot

DELETE 325.20 in its entirety and **REPLACE** with the following:

Item 325.24 For 24 Inch Steel Pipe Casing for Water Pipe, per foot

ITEM 1-2: SECTION 00300 – Bid Schedule for Add Alternate #1

Item 371.20 For 20 Inch Coupling, per each

DELETE 371.20 in its entirety and **REPLACE** with the following:

Item 371.24 For 24 Inch Coupling, per each

ITEM 1-3: SECTION 00900 – SPECIFICATIONS

Item 325.20 For 20 Inch Steel Pipe Casing for Water Pipe, per foot

DELETE 325.20 in its entirety and **REPLACE** with the following:

ITEM 325.20 20 INCH STEEL PIPE CASING FOR WATER PIPE FOOT

ITEM 325.24 24 INCH STEEL PIPE CASING FOR WATER PIPE FOOT

This work item shall consist of furnishing and installing 20” steel sleeve and 24” steel sleeve at the locations shown on the Plans and/or as directed by the Engineer.

MATERIALS:

At the Ipswich River crossing, the steel sleeve shall be 20” diameter steel casing, 0.5” thick to host the new water main. The 20” steel casing pipe shall be installed in accordance with MassDOT Standards. Spacers shall be attached to the 12” ductile iron water pipe, attachment to the insulation is not permitted. Payment for the spacers and casing end seals is incidental to the casing pipe.

At the MBTA Railroad crossing, the steel sleeve shall be 24” diameter steel casing, 0.5” thick to host the new water main and two end caps. The 24” steel casing pipe shall be installed in accordance with MBTA pipeline occupancy specifications. Spacers shall be attached to the 12” ductile iron water pipe, attachment to the insulation is not permitted. Payment for the spacers and casing end seals is incidental to the casing pipe.

CONSTRUCTION METHODS:

The Contractor shall install the 20” steel sleeve and the 24” steel sleeve at the locations shown on the Plans and/or as directed by the Engineer. End casing seals shall be installed at the end of the pipe.

The steel sleeve shall have interior lining that includes cement mortar per AWWA C205 and exterior coating that includes Polyurethane per AWWA C222.

METHOD OF MEASUREMENT:

This item shall be measured by the number of linear feet actually installed in accordance with the Plans and/or as directed by the Engineer.

BASIS OF PAYMENT:

The accepted quantity of this item shall be paid for at the contract unit price per “Linear Foot” as listed in the proposal. The price so stated constitutes full and complete compensation for all labor, material, equipment including steel sleeve, fittings, gaskets, fabrications, welding, welded joints, end casing seals, excavation, bedding material, placing and compacting backfill, and all other incidentals required to complete the work, complete in place and accepted by the Engineer.

ITEM 1-4: SECTION 00900 – SPECIFICATIONS

Item 371.20 20 Inch Coupling Each

DELETE 371.20 in its entirety and **REPLACE** with the following:

ITEM 371.24 24 INCH COUPLING

ITEM 1-5: Contract Drawing Sheet 4 of 18

DELETE Contract Drawing Sheet 4 of 18 and **REPLACE** with the Attached Drawing (Sheet 4 of 18).

Town of Wilmington

Date: March 25, 2024

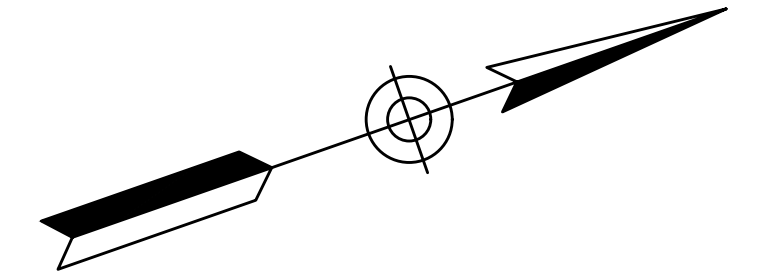

LIMITS OF ADD ALTERNATE NO. 1
STA 1+00 TO STA. 15+00

LIMITS OF BASE CONTRACT
STA 15+00 TO STA. 39+50

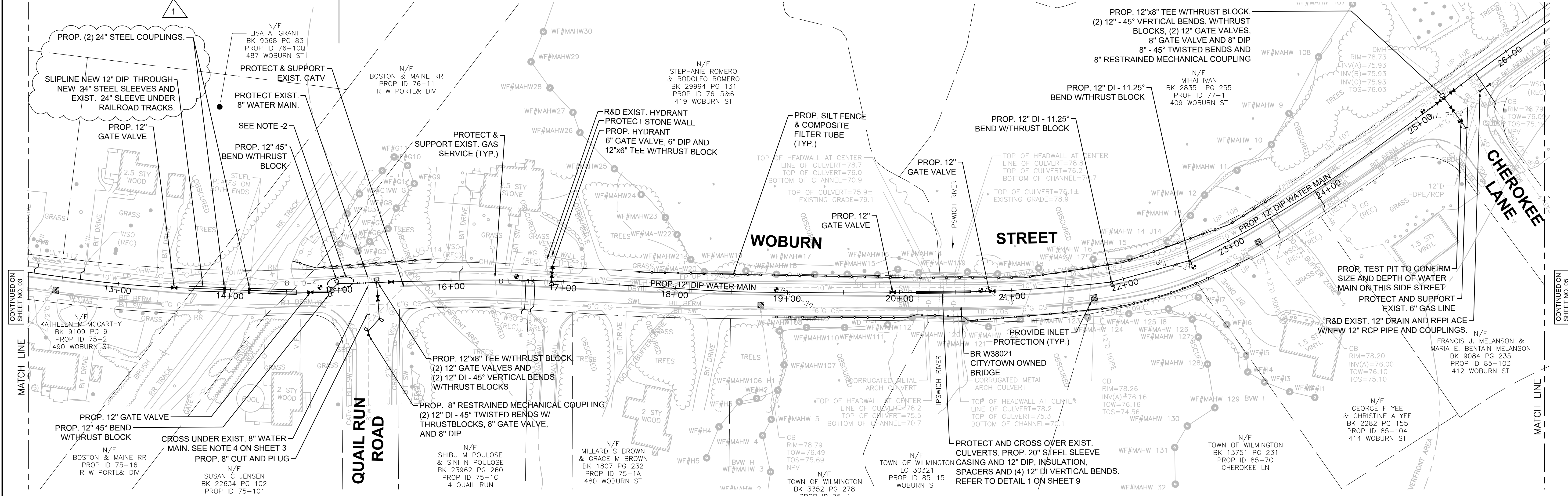

CONTINUED ON SHEET NO. 03

CONTINUED ON SHEET NO. 03

- NOTES:
- SEE NOTE 1 ON SHEET 3
 - REFER TO DETAIL 2 ON SHEET 9. THE PROPOSED CONNECTION DETAIL SHOULD BE USED TO CONNECT THE NEW 12" WATER MAIN TO EXISTING 10" WATER MAIN (IF ADD ALTERNATE NO. 1 IS NOT SELECTED BY THE TOWN).

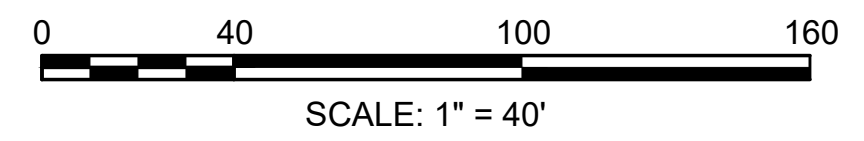

WATER MAIN REPLACEMENT WOBURN STREET	
DESIGN SUBMISSION:	BID DOCUMENTS
DRAWING TITLE:	WATER SUPPLY PLANS
PREPARED FOR:	TOWN OF WILMINGTON
PREPARED BY:	 GREEN INTERNATIONAL AFFILIATES, INC. Civil and Structural Engineers (978) 923-0400 TEWKSBURY, Massachusetts GreenIntf.com

SCALE: 1" = 40'	DESIGNED BY: SK	SHEET NO. 04 OF 18
DATE: 02/19/2024	DRAWN BY: SK/KT	
PROJECT NO. 22131	CHECKED BY: HG/SS	

NO.	DATE	REVISIONS
1	3/19/24	24" STEEL SLEEVE

Y:\SHARED\ENGINEERING\PROJECTS\2022\22131\DWG\CURRENT DESIGN\ENGINEERING WORKING\WATER SUPPLY PLANS.DWG